

EVENTS OF THE FUTURE

EUREF-CAMPUS DÜSSELDORF



WHY EUREF CAMPUS DÜSSELDORF?

- **Net zero ready**
powered by renewables
- **Connected to Europe & the world**
by air, rail & road
- **Surrounded by innovation**
energy, mobility & climate pioneers
- **Future-proof infrastructure**
smart, flexible, digital
- **A place that reflects your values**
sustainability, excellence, inspiration



Runway – Düsseldorf Airport

Düsseldorf Airport
Station

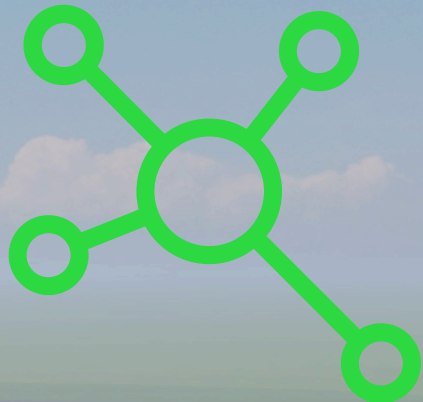

- 350+ daily train
- 25 min bike to city
- 5 min train to D'dorf
Main Station
- 5 min SkyTrain to
DUS Airport

Pool

- 80k m² office & event
Space
- 4k employees
- 2045 climate goals –
achieved from day
one

Beach Court

FUTURE HUB 2.0

Direct A44 motorway
access

Lake Lichtenbroich

PERFECT MATCH OF PLACE & PURPOSE

Shaping Düsseldorf's Future – Your Sustainable Event Destination.

- More than a venue: A first-mover driving the city and region towards a sustainable future.
- Proudly partnering with the city of Düsseldorf, Düsseldorf Airport, and Düsseldorf Convention.

A living lab of smart tech and renewables, directly contributing to the city's 2035 CO₂ targets from day one.

**Düsseldorf
Convention
Partner**

**Düsseldorf
Airport** **DUS**

EVENT SPACES

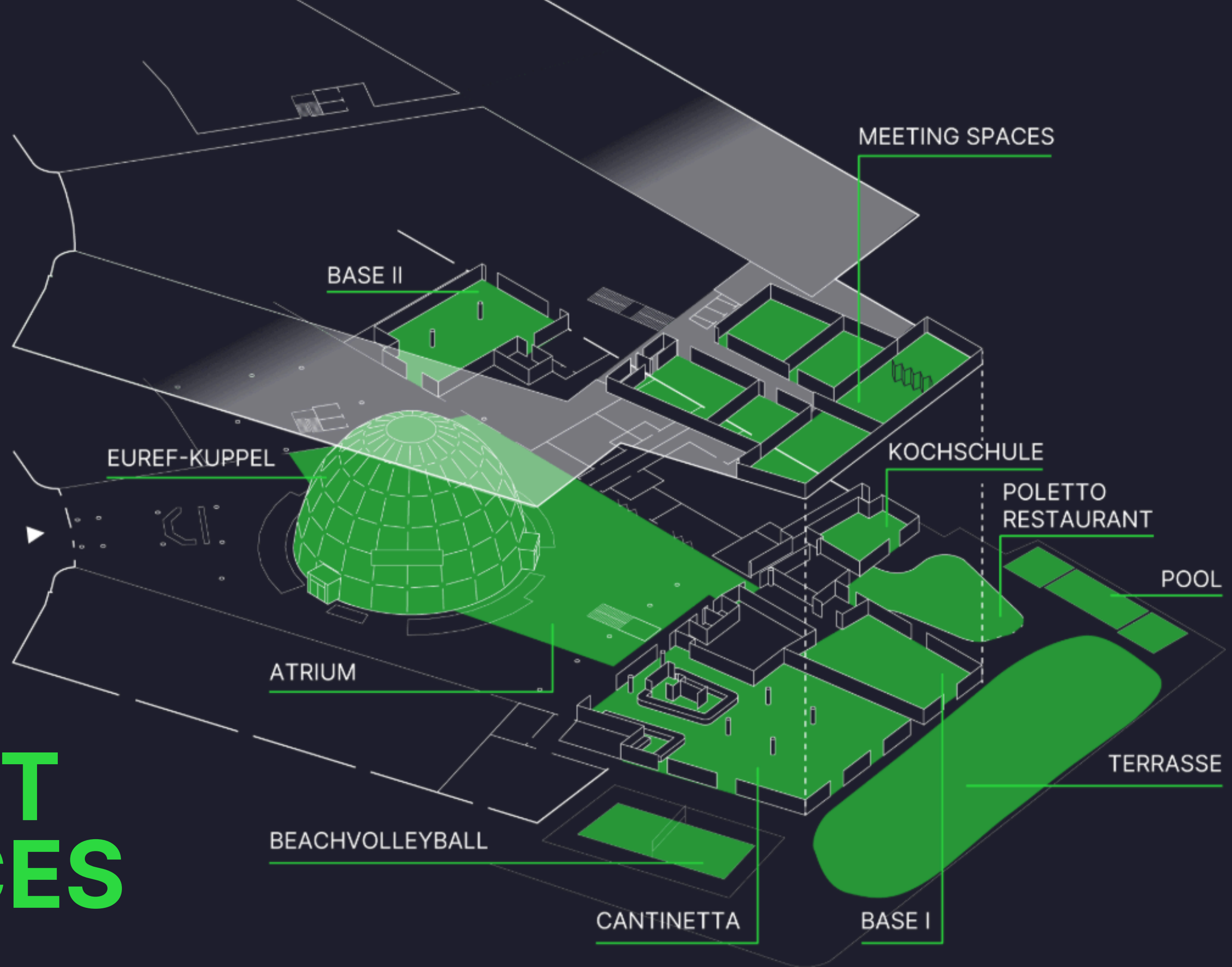



EUREF DOME

GROUND FLOOR



832 
600 



EUREF DOME

AREA	832 m ²
HEIGHT	21,0 m ²
WIDTH	29,5 m ²
LENGTH	29,5m ²



600



250



350

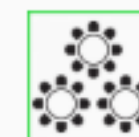

280



600



EUREF ATRIUM

GROUND FLOOR

854

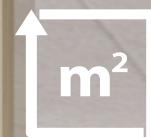

500







ENTRANCE

BASE 1



FLEX SPACES

GROUND FLOOR

342 
195 

BASE 2



308 
200 

MEETING SPACES

FIRST FLOOR

7 rooms
86-186  m²



MEETING SPACES



An architectural rendering of a modern, bright interior space, likely a cafe or restaurant. The room features large windows and glass doors that offer a view of an outdoor terrace and a lake. The interior is furnished with wooden tables and chairs, and a large blue sofa. Several large, white, spherical pendant lights hang from the ceiling. A large green plant is positioned in the foreground on the right. A green banner at the bottom left contains the text "CANTINETTA" and "GROUND FLOOR".

CANTINETTA

GROUND FLOOR

942  m²
300 



OURDOOR

TERRACE, POOL, BEACH

961 
400 

TERRACE



POOL



BEACH COURT







COOKING STUDIO

COMING SOON

90  m²
18 

POLETTO RESTAURANT

COMING SOON

178  m²
60 

UNITED FOR SUCCESS: OUR PARTNERS IN DÜSSELDORF

EUREF *Event*★

**LOCATION & EVENT
MANAGEMENT**

12 years of event
experience



CORNELIA POLETTTO

**GASTRONOMIC
DIRECTOR**

Over 25 years of top
gastronomy



**GASTRONOMIC
PARTNER**

111-year
success story



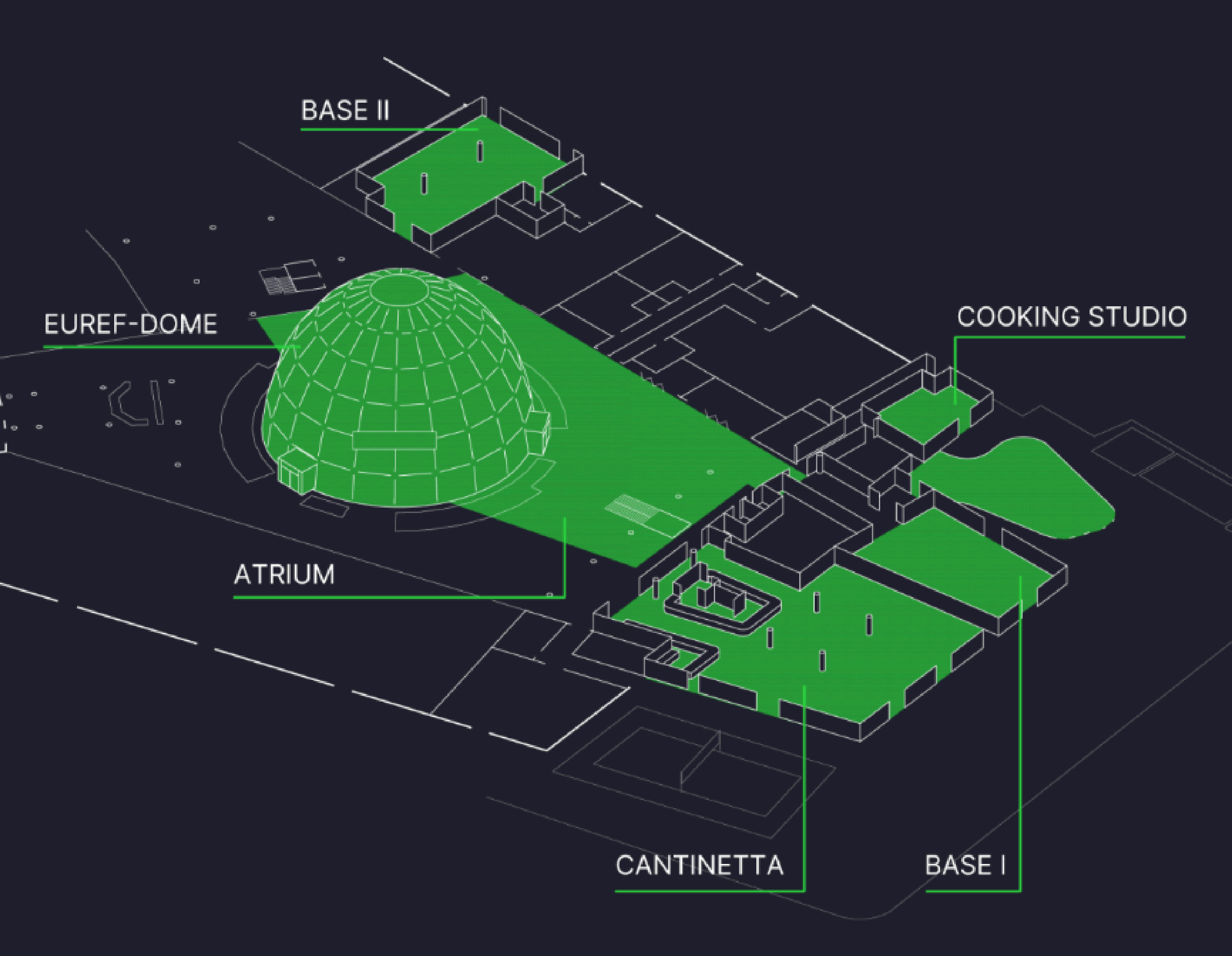

GROUND FLOOR

EUREF DOME	832 m ²
EUREF ATRIUM	854 m ²
BASE 1	342 m ²
BASE 2	308 m ²
CANTINETTA	942 m ²
COOKING STUDIO	90 m ²
OUTDOOR	961 m ²

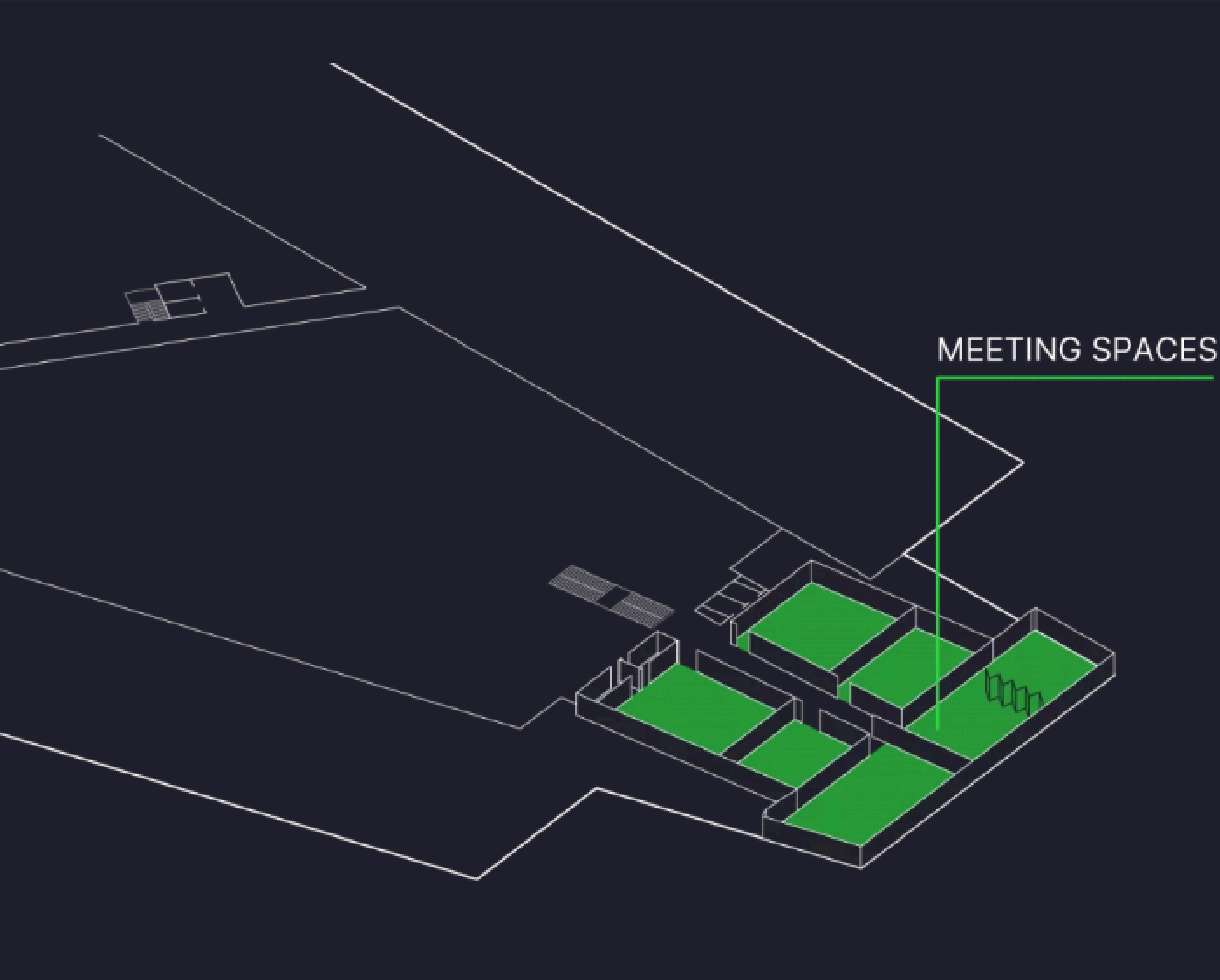

FIRST FLOOR

FIELD SIDE 1	130 m ²
FIELD SIDE 2	102 m ²
LAKESIDE 1	97 m ²
LAKESIDE 2	89 m ²
combined	186 m ²
BEACHSIDE	152 m ²
GREENSIDE 1	142 m ²
GREENSIDE 2	86 m ²