

**EUREF** *Event*★

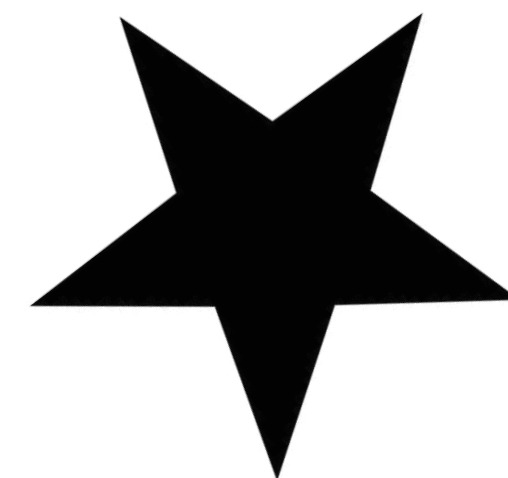

# **EUREF CAMPUS BERLIN**

**#EventsoftheFuture**





# OUR VISION

Our vision is to be Europe's leading "**Event Location +**", setting new standards through innovative spaces and sustainability. Our goal is to support the global climate goals and to live our values of innovation, sustainability and community in every event.

EUREF Event is responsible for the event management of the EUREF-Campus Berlin, the CO<sub>2</sub>-neutral innovation hub. **Over 7,000 employees** in more than **150 companies** are dedicated to the topics of energy, mobility and climate change as well as research and education.





## YOUR BENEFITS

---

The EUREF-Campus Berlin offers far more than just event spaces – it combines innovative architecture, sustainable infrastructure and forward-thinking event concepts. The “+” stands for our added value: as a creative hub for energy, mobility and climate protection, it provides an inspiring atmosphere for events that bring innovation and sustainability to life.



### VARIETY OF LOCATIONS

The right setting for every occasion



### FOCUS ON SUSTAINABILITY

Climate-friendly venues are part of a vision for a green future

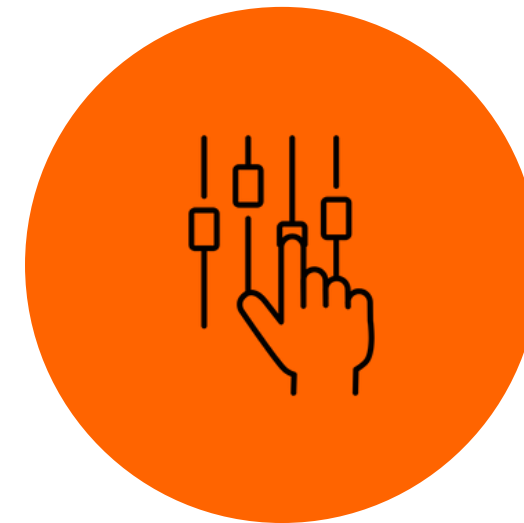

### ONE-STOP-SHOP

Location, catering, technology & community



### POWER OF IDEAS

A strong network of experts and partners



# BEST OF EVENTS

## Events at the Pulse of the Future

It is a place where visionaries from politics, business, and science come together to shape the future. In inspiring spaces and with state-of-the-art technology, we bring your event to life – creating experiences that set new standards.

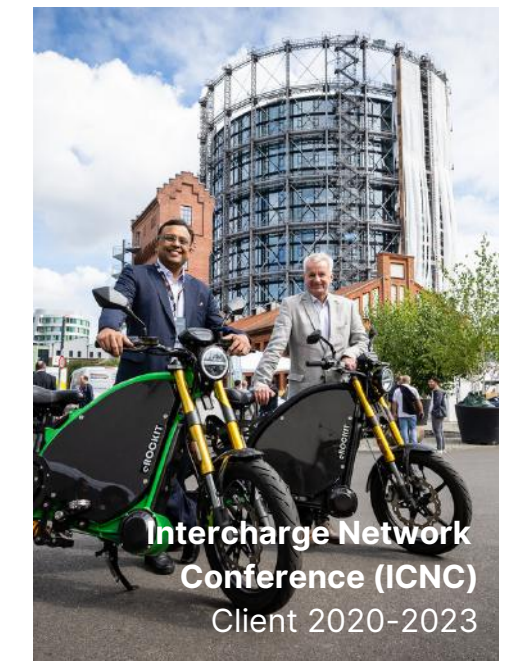
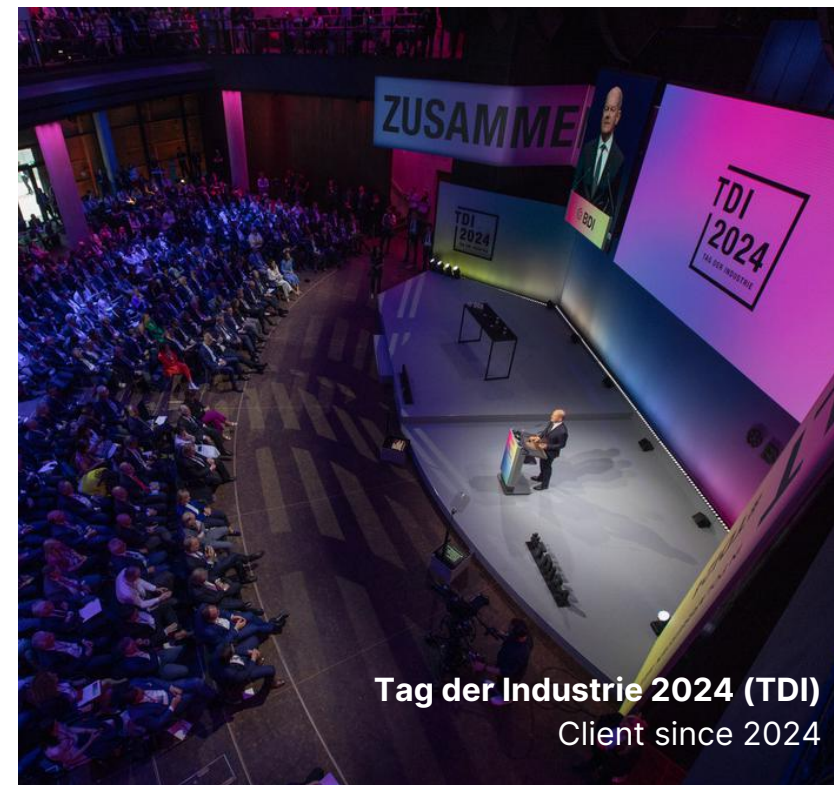



# 10 LOCATIONS

**EUREF** *Event*★

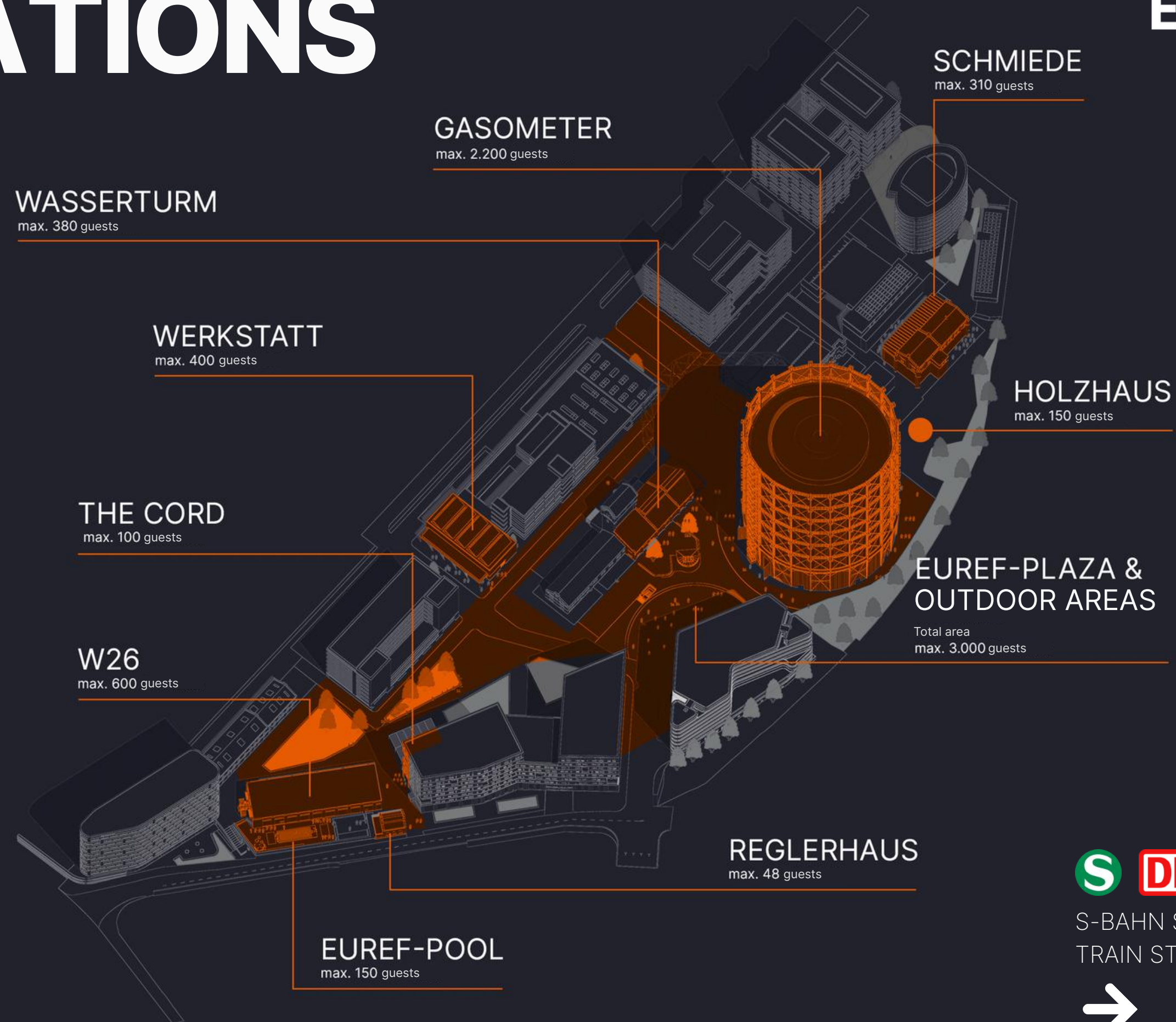

S-BAHN STATION SCHÖNEBERG



S-BAHN STATION & INTERCITY  
TRAIN STATION SÜDKREUZ





# GASOMETER

ICONIC. HISTORIC. IMPRESSIVE.





# GASOMETER

**EUREF** Event<sup>★</sup>

The heart of the EUREF-Campus opens its steel doors after 100 years: the listed gasometer shines in new splendor – as an energy-efficient office and event building with a unique character of architecture and interior in an industrial look.

Multiple spaces in different layers - with a **spectacular highlight**: the roof terrace at a height of 66 meters with a breathtaking 360° view of Berlin.



## ■ KEY FACTS

up to 3.500 

2.200 

## ■ SPACES

> **BASE:**  
450m<sup>2</sup> | 500 guests

> **FORUM:**  
725m<sup>2</sup> | 980 guests

> **CLUB:**  
389m<sup>2</sup> | 340 guests

> **SKY:**  
546m<sup>2</sup> | 300 guests

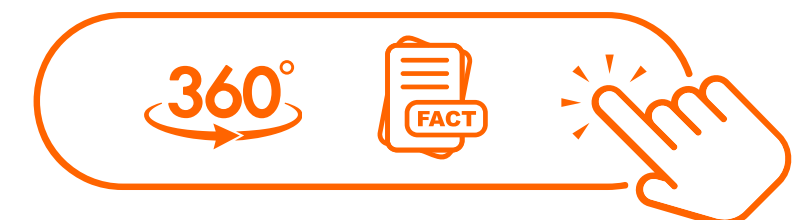





**W26**

ONE SPACE. ENDLESS POSSIBILITIES.



# W26



**EUREF Event**★

The W26 offers a 670 m<sup>2</sup> of space for individual, tailor-made event formats for up to 600 guests.

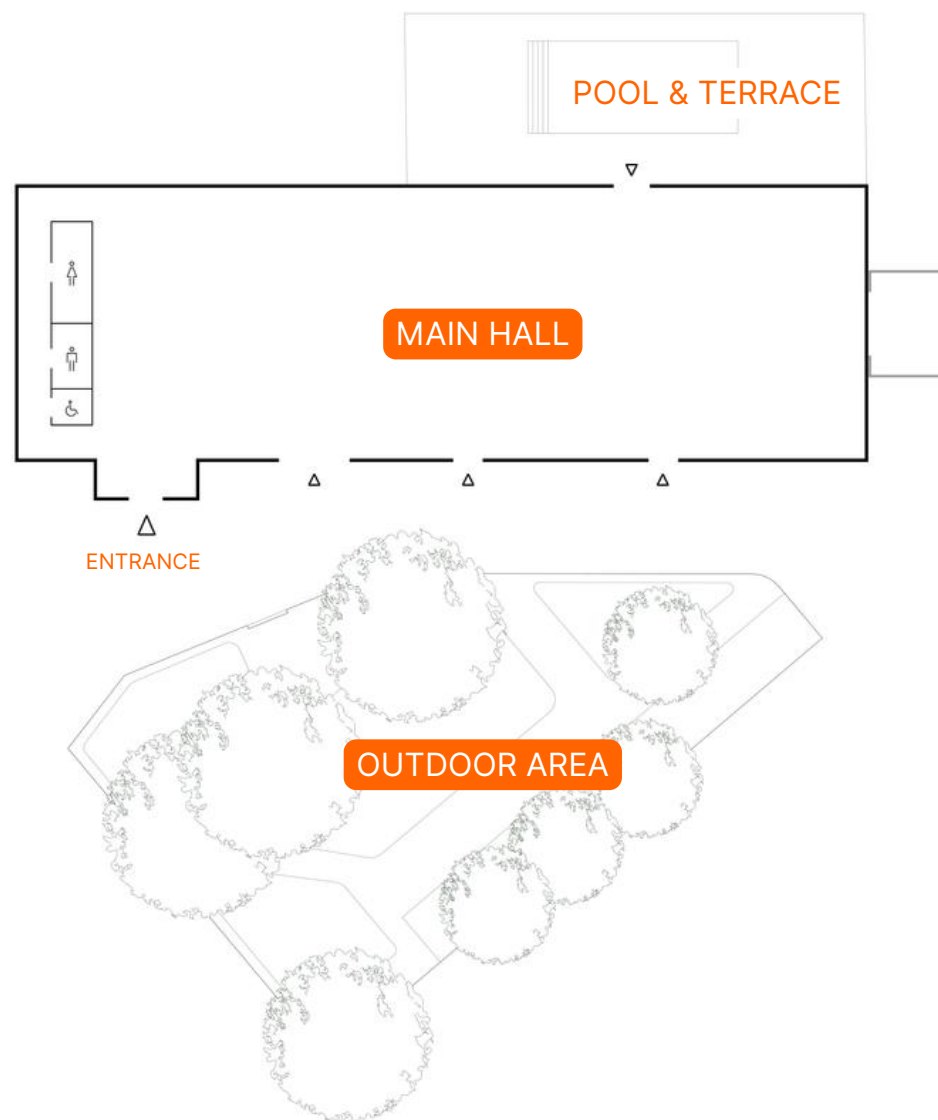
With its 6-meter-high pillarless ceiling and wide roll up doors, W26 is ideal for product presentations and large-format exhibits, among other things.



## ■ KEY FACTS

670  **INDOOR**  
600  excl. outdoor area

## ■ SPACES

- **Main hall:**  
670m<sup>2</sup> | 600 guests
- **Outdoor area:**  
1.250m<sup>2</sup> | 600 guests

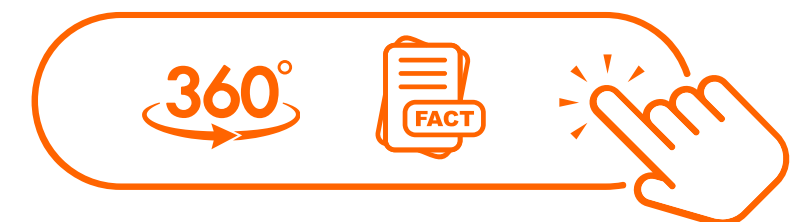



# WERKSTATT

INDUSTRIAL LOFT FOR  
DYNAMIC EVENTS





# WERKSTATT



**EUREF** Event<sup>★</sup>

High ceilings, wide roll up doors, a light-flooded event hall – the ‘Werkstatt’ (workshop) is the perfect stage for events with plenty of room for creativity.

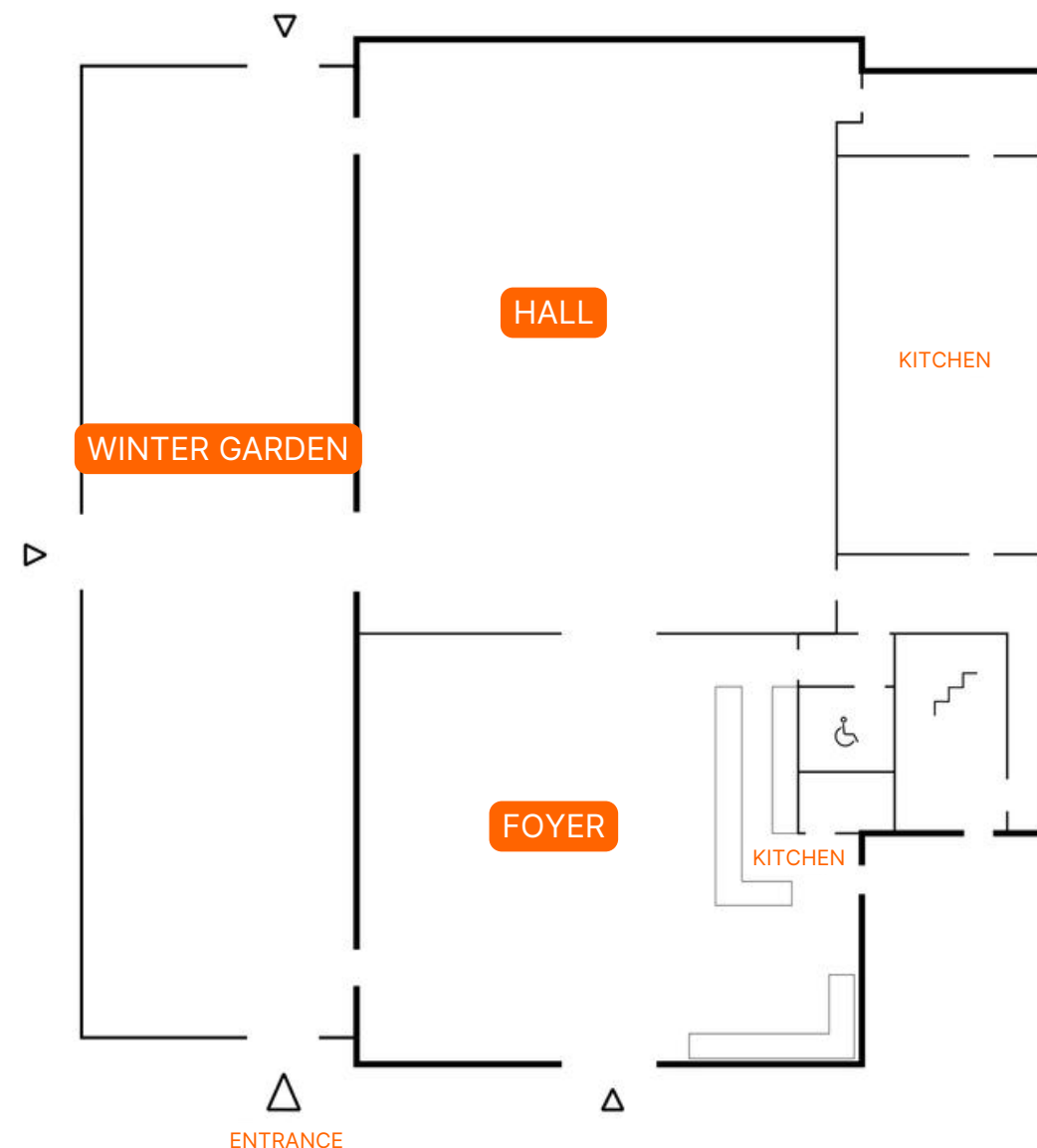
With a covered outdoor area and seamlessly integrated catering space, every event moment leaves an impression. The open loft character and dynamic start-up flair create room for innovation and networking.



## ■ KEY FACTS

395  **INDOOR**  
400  excl. semi-outdoor  
winter garden

## ■ SPACES

- > **Foyer:**  
130m<sup>2</sup> | 150 guests
- > **Hall:**  
265m<sup>2</sup> | 250 guests
- > **Winter garden:**  
255m<sup>2</sup> | 150 guests





# WASSERTURM

MULTI-PURPOSE VENUE WITH  
RUSTIC BRICK CHARM





# WASSERTURM

**EUREF** Event<sup>★</sup>

Built in 1924, the 'Wasserturm' (former water tower) combines an impressive brick ambience with modern event technology.

The Audimax, two flexible seminar rooms and the adjoining café with a large terrace offer space for conferences or exhibitions.

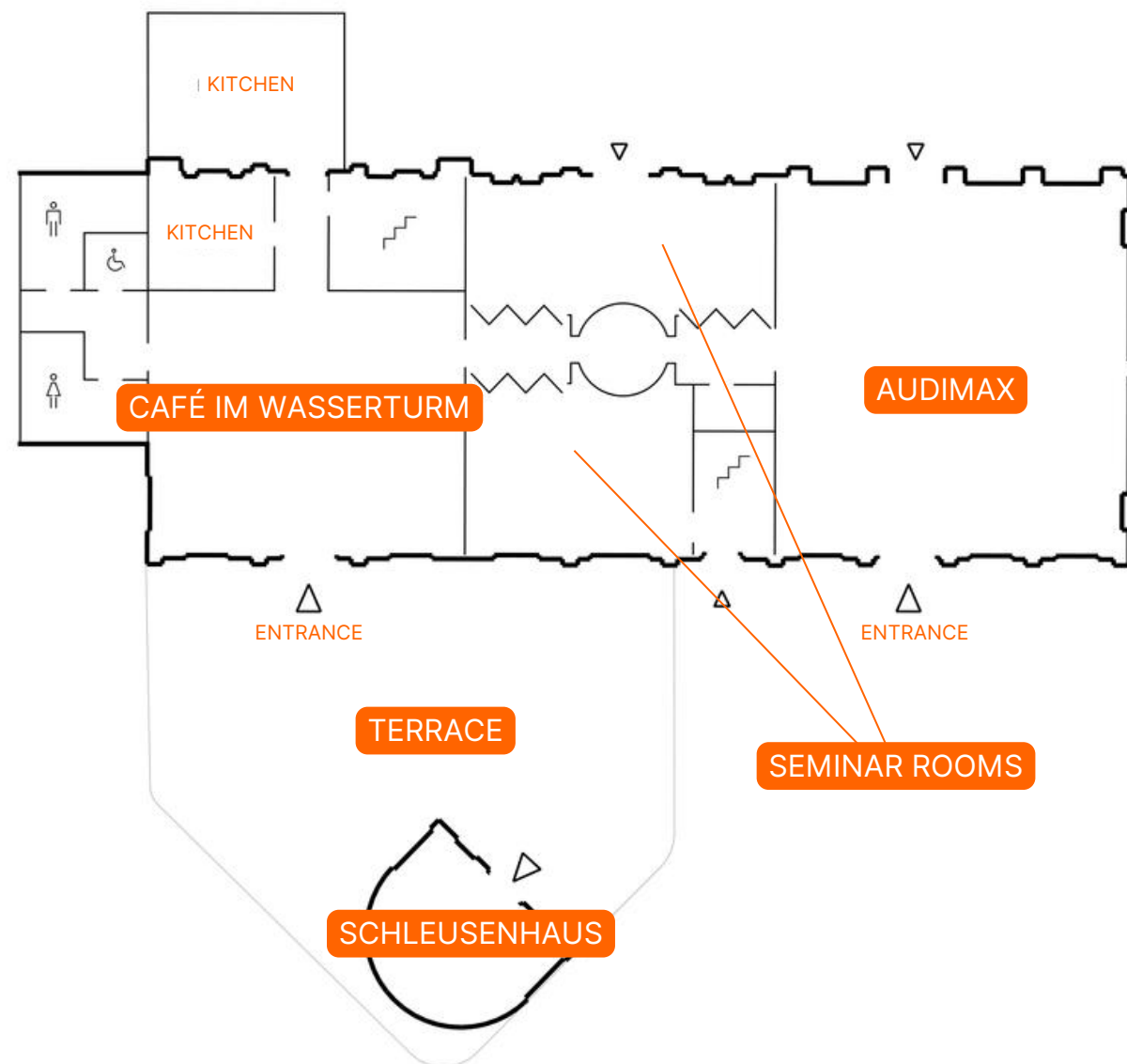

## ■ KEY FACTS

473  **INDOOR**  
excl. terrace

380 

## ■ SPACES

- > **Audimax:**  
210m<sup>2</sup> | 180 guests
- > **Café & Restaurant:**  
125m<sup>2</sup> | 100 guests
- > **Seminar rooms**  
138m<sup>2</sup> | 100 guests
- > **Terrace:**  
220m<sup>2</sup> | 150 guests

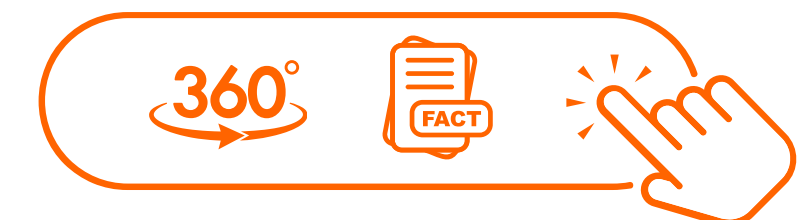





## **SCHMIEDE**

HISTORIC. CHARMING. SPACIOUS.



# SCHMIEDE

**EUREF Event**★

The Restaurant Schmiede is a former smithy, a facility in the gasworks, where tools were manufactured and repaired. Now it is the perfect event location: Two flexible rooms with a brick look, a winter garden, terraces and a spacious outdoor amphitheater create unforgettable experiences for up to 300 guests.

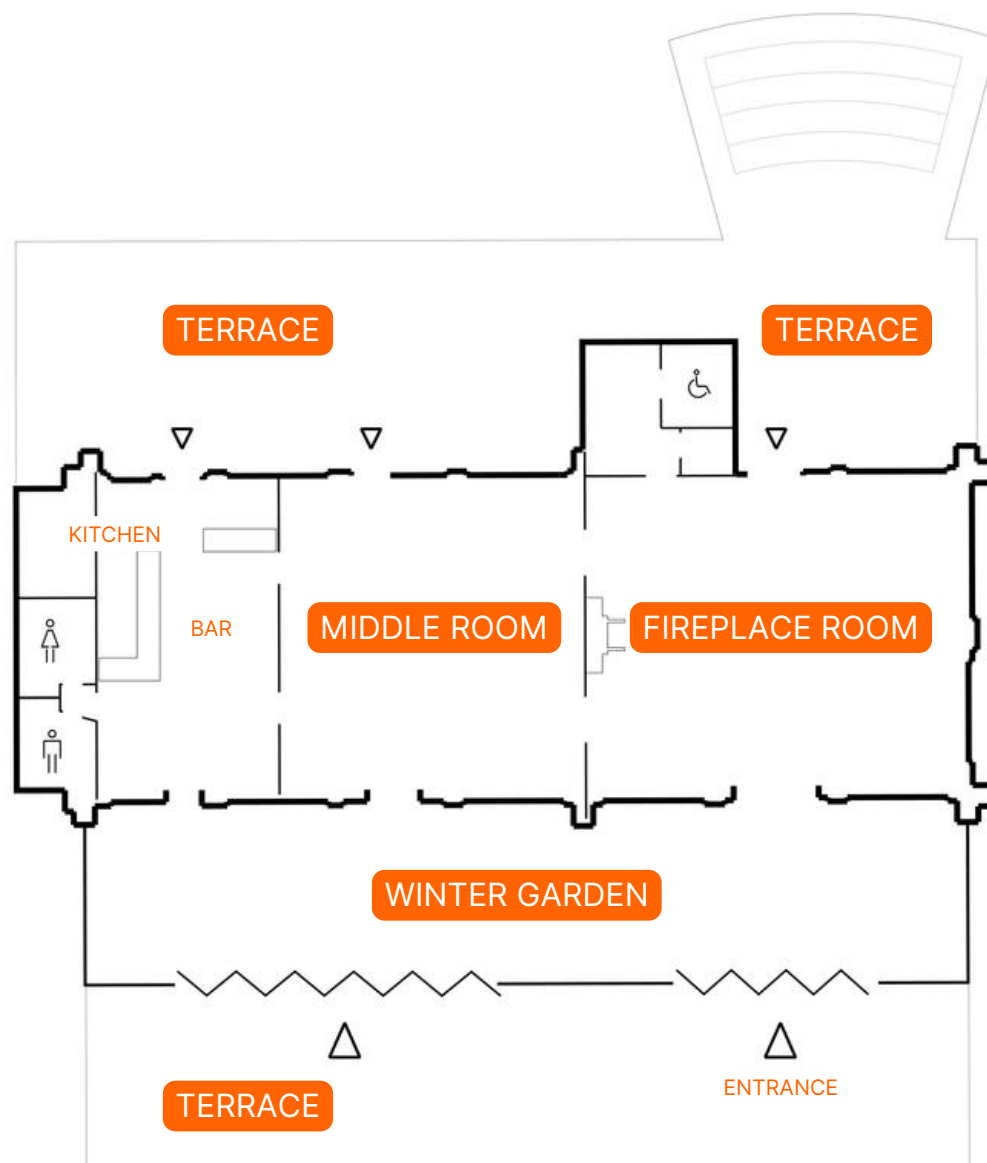

## ■ KEY FACTS

389  **INDOOR**  
excl. terraces  
310 

## ■ SPACES

- **Middle room:**  
95m<sup>2</sup> | 80 Personen
- **Fireplace room:**  
120m<sup>2</sup> | 80 guests
- **Winter garden:**  
174m<sup>2</sup> | 150 guests
- **Terraces**  
340m<sup>2</sup> | 200 guests

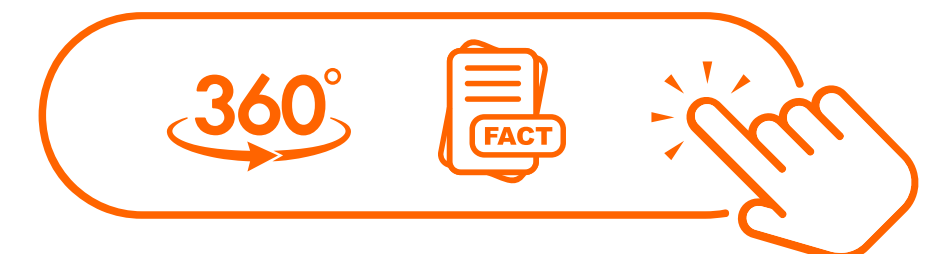



# REGLERHAUS

URBAN OASIS WITH  
YEAR-ROUND ELEGANCE





# REGLERHAUS



**EUREF** Event<sup>★</sup>

The historic gaswork control building was a key facility in a gasworks, housing pressure regulators and control mechanisms to ensure a stable and safe distribution of gas.

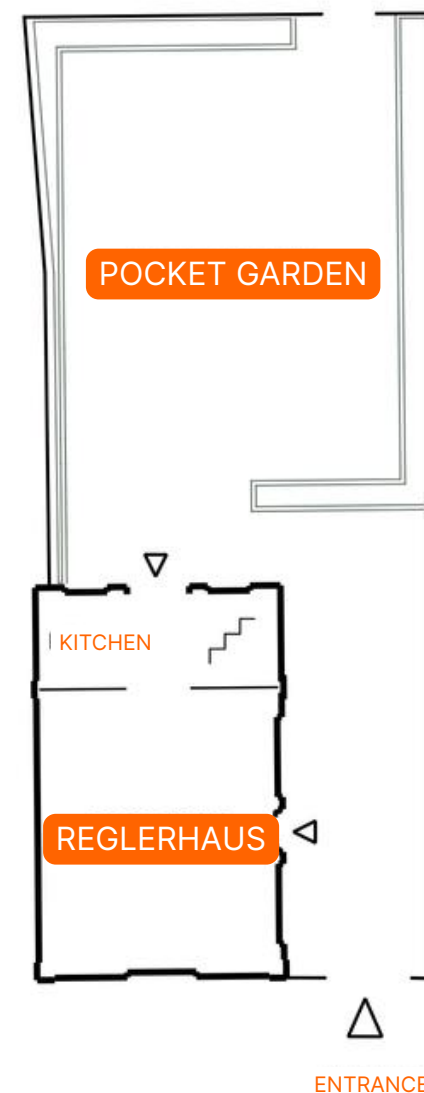
The lovingly restored historic building offers exclusive dinners and intimate conferences for up to 48 people.



## ■ KEY FACTS

50  **INDOOR**  
48  excl. Pocket garden

## ■ SPACES

- > **Reglerhaus:**  
50m<sup>2</sup> | 48 guests
- > **Pocket garden:**  
81m<sup>2</sup> | 40 guests

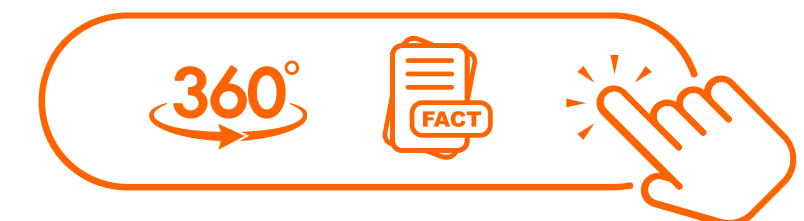





## THE CORD

EXCLUSIVITY MEETS INNOVATION



# THE CORD

**EUREF** Event<sup>★</sup>

With a focus on sustainability and regionality, the restaurant offers new classics that inspire through sophistication and the highest quality – perfect for exclusive events.

Inspired by the “**Cord 810/812**” from 1937, the first streamlined vehicle, the restaurant embodies innovation and pioneering spirit, just like the sustainable mobility concepts on the EUREF-Campus.

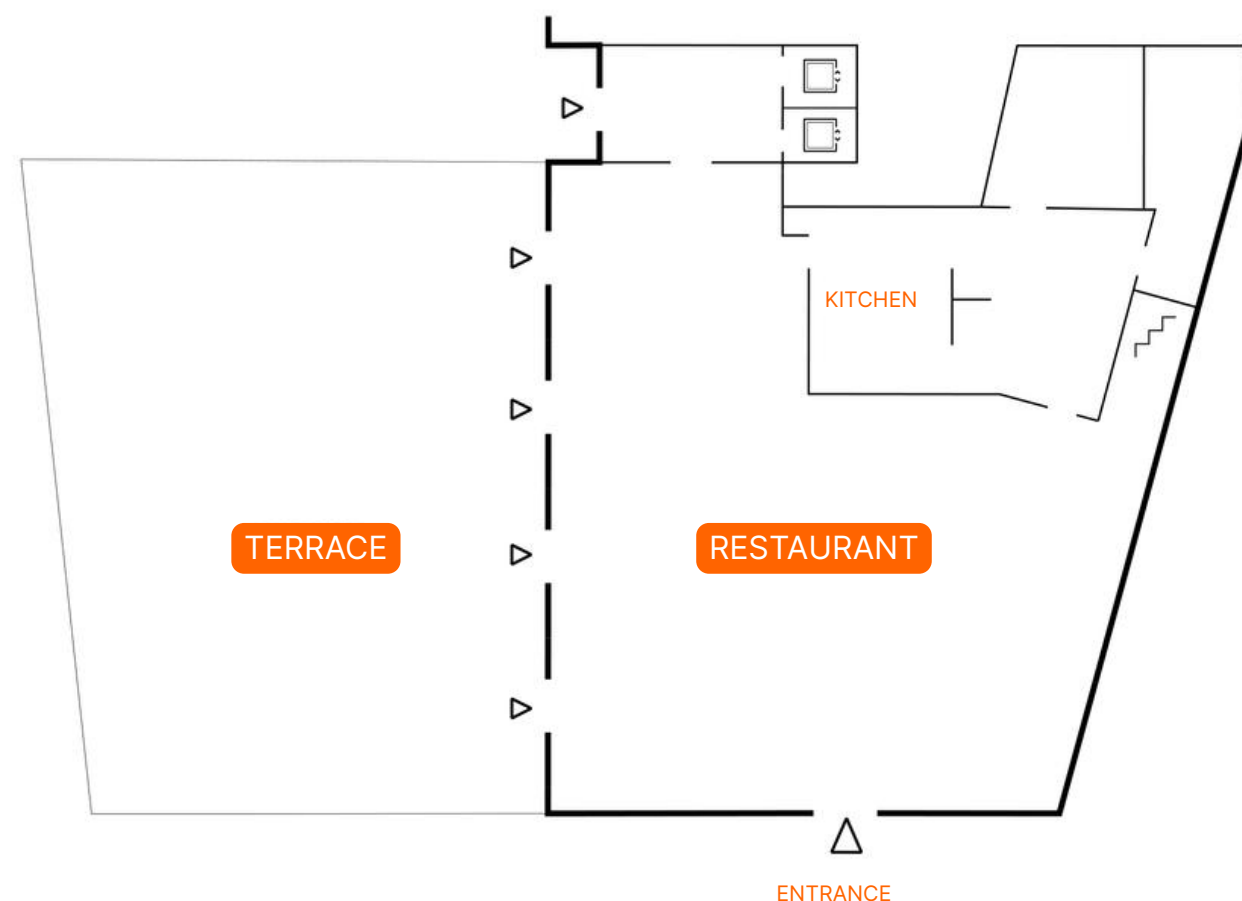

## ■ KEY FACTS

305  **INDOOR**  
excl. terrace

104 

## ■ SPACES

- **Restaurant:**  
305m<sup>2</sup> | 104 guests
- **Terrace:**  
336m<sup>2</sup> | 150 guests





## **EUREF-POOL**

A SUMMER OASIS FOR  
MEMORABLE EVENTS





# EUREF-POOL

**EUREF** *Event*★

## The star among the event locations!

Whether it's a summer party, team event or sundowner with cocktails & BBQ – the EUREF Pool offers a stylish backdrop for unforgettable events. Thanks to its exclusive location on the campus and separate access point, you can enjoy maximum privacy.

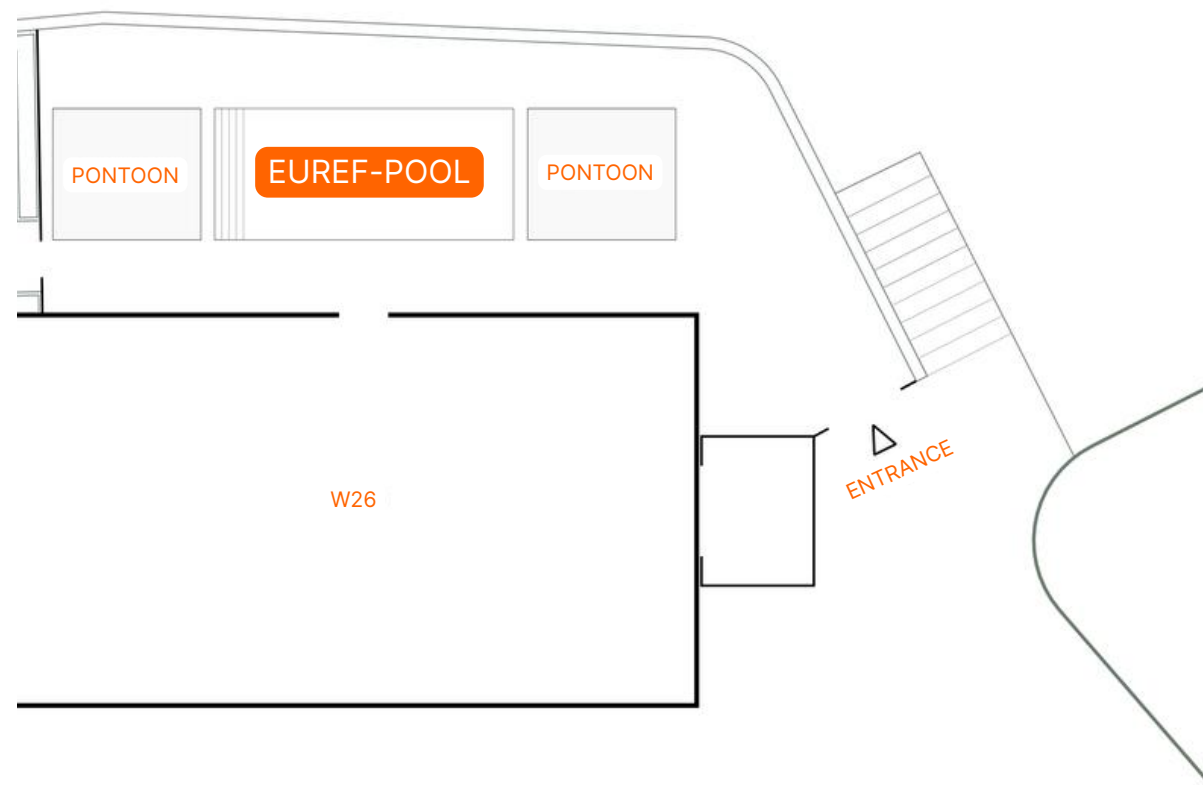

## ■ KEY FACTS

250 

150 

## ■ SPACES

➤ with open Pool:  
257m<sup>2</sup> | 150 guests

➤ with closed pool:  
335m<sup>2</sup> | 150 guests

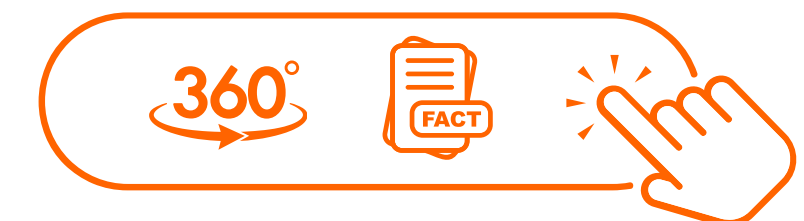



## **EUREF-PLAZA**

OUTDOOR EVENTS IN THE HEART  
OF THE CAMPUS





# EUREF-PLAZA

**EUREF** *Event*★

With space for up to 2,000 guests, the EUREF-Plaza offers the largest open space for events of all kinds. Surrounded by iconic buildings such as the water tower and the gasometer, this location is ideal for summer parties, networking events, or product presentations – all in the open air.

## ■ KEY FACTS

2.000 

2.000 

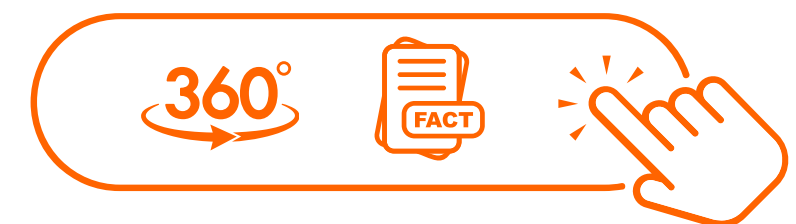
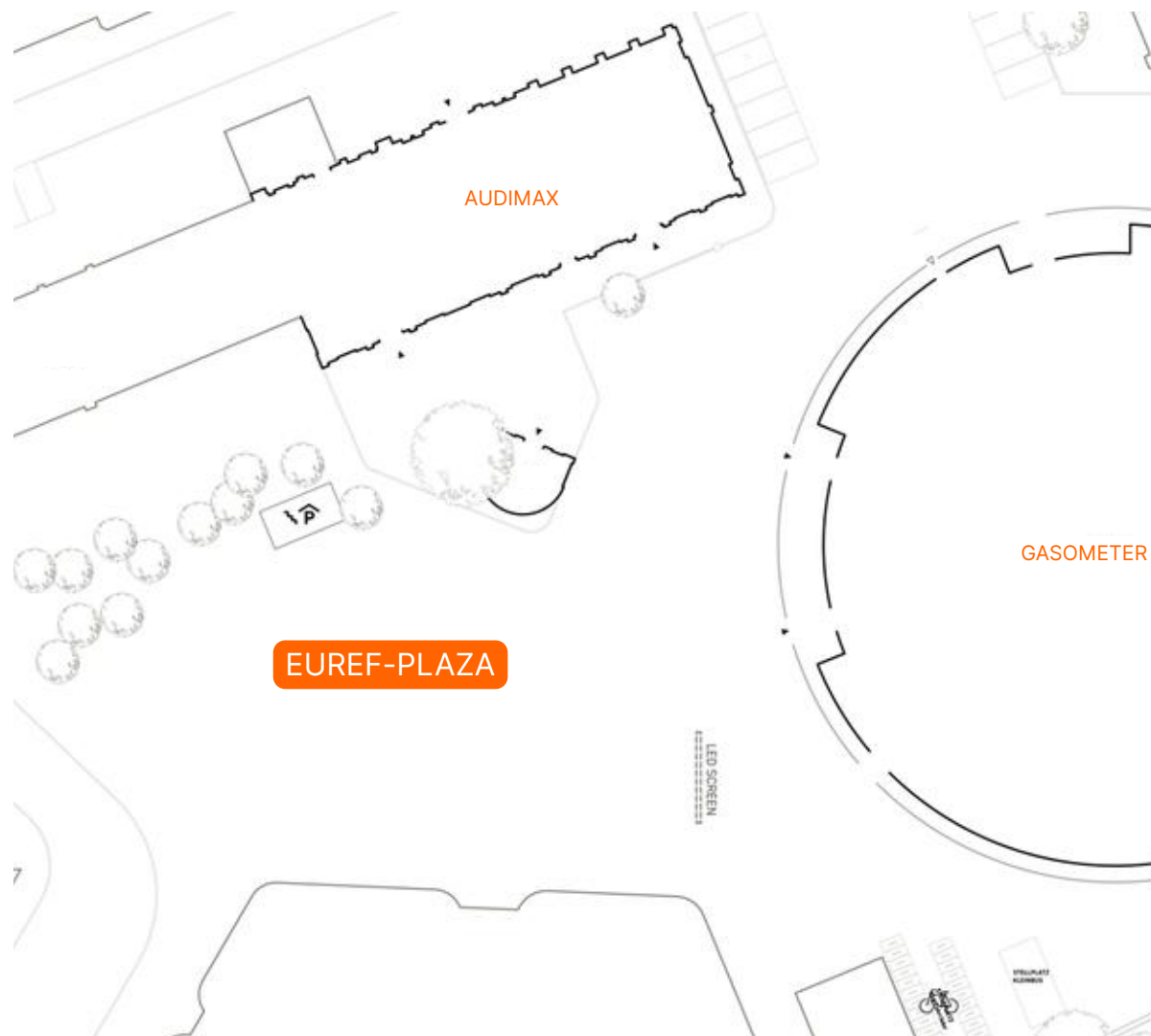



# HOLZHAUS

SUSTAINABLE BREAKOUT ROOMS  
FOR GREAT IDEAS





# HOLZHAUS

**EUREF** Event<sup>★</sup>

The 'Holzhaus' – a wooden house – offers the perfect setting for workshops, meetings, artists' dressing rooms, and creative sessions. Equipped with its own showers, toilets, and pantry kitchen, it ensures maximum comfort.

**Get ready for sporting team events and summer parties on our new beach volleyball court – opening May 2025!**

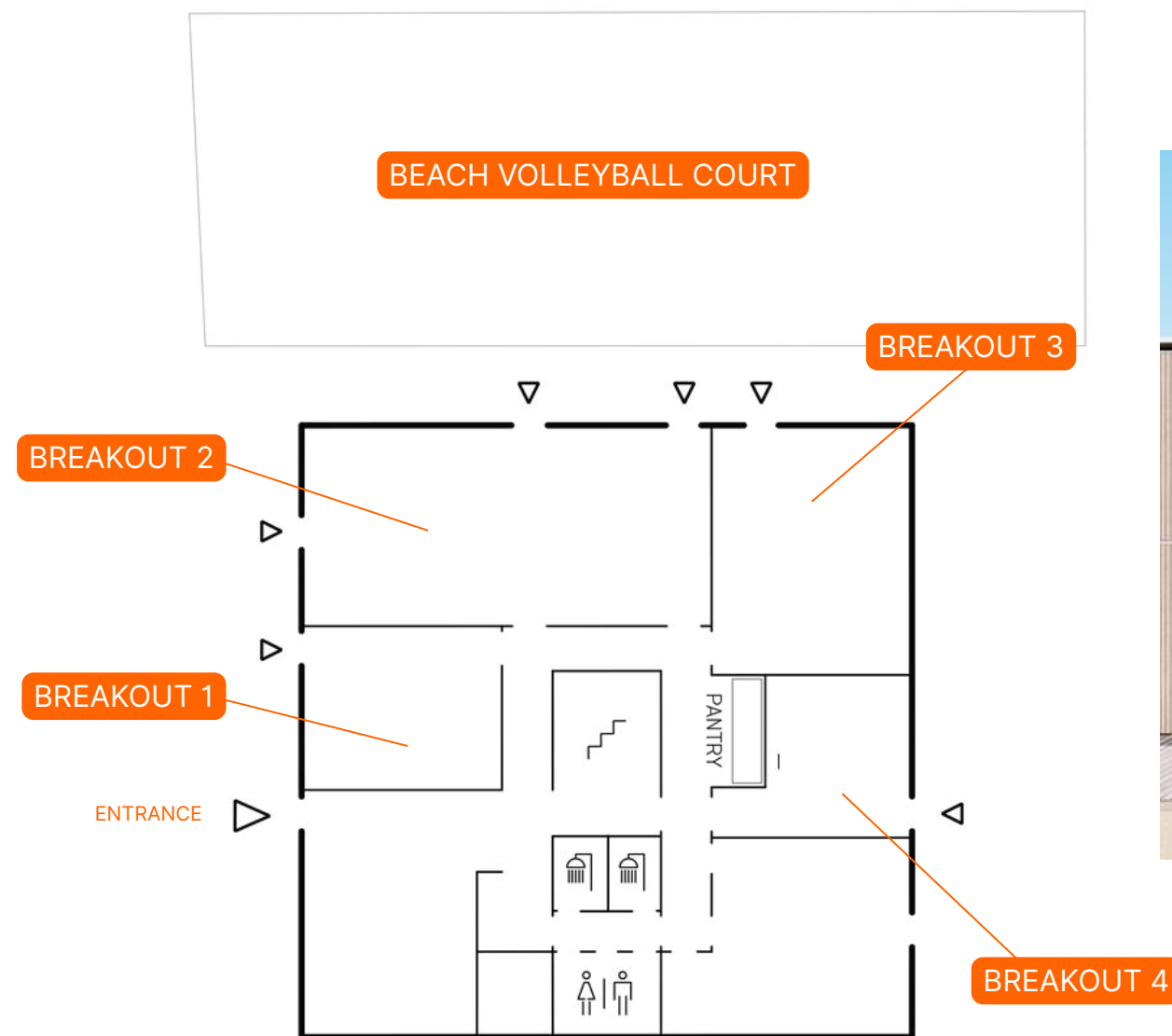

## ■ KEY FACTS

178 

153 

## ■ SPACES

- **Breakout 1:**  
31m<sup>2</sup> | 24 guests
- **Breakout 2:**  
77m<sup>2</sup> | 77 guests
- **Breakout 3:**  
45m<sup>2</sup> | 42 guests
- **Breakout 4:**  
25m<sup>2</sup> | 10 guests

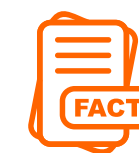



# ONE-STOP-SHOP

EUREF *Event*★

## EVERYTHING FROM A SINGLE SOURCE

---

With tailor-made event solutions, excellent catering and sustainable standards, we create experiences that shape the future. As a **one-stop-shop**, we bring our expertise together and ensure that your event runs smoothly.



### LOCATIONS

Symbiosis of old and new:  
heritage-protected  
buildings meet modern  
green buildings

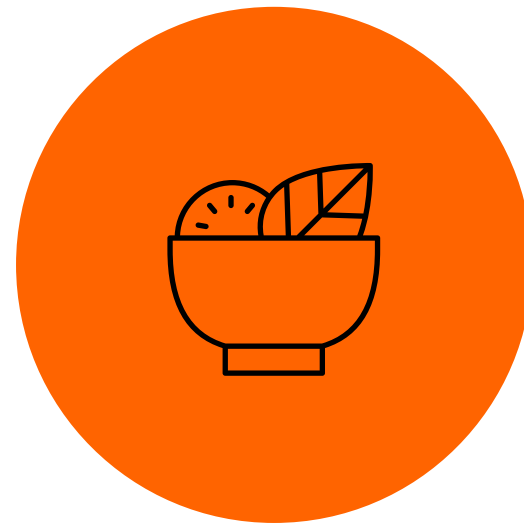

### CATERING

Seasonal, regional, sustainable  
- with a special focus on  
vegetarian and vegan diversity

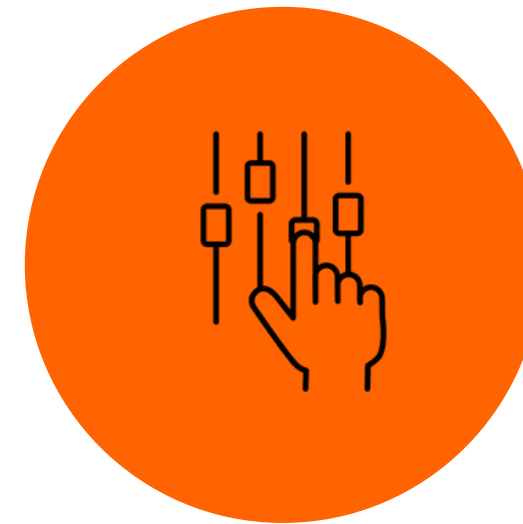

### TECHNOLOGY

State-of-the-art technology  
with CO<sub>2</sub>-neutral energy and  
smart lighting systems



### COMMUNITY

Added value through our  
active community in the  
areas of mobility, energy  
and climate protection





# CATERING

YOU ARE WHAT YOU EAT

EUREF Event<sup>★</sup>

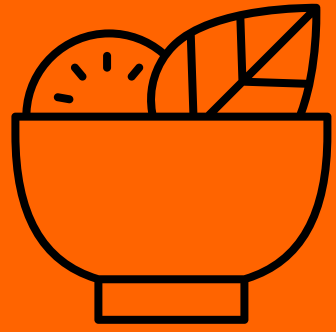

A culinary experience that is regional, seasonal, and sustainable – with a focus on fresh, flexible vegetarian and vegan variety. Guided by star chef Thomas Kammeier, we serve high-quality, local ingredients that ensure both enjoyment and well-being. **Discover our three unique worlds of taste:** HEIMAT with modern comfort dishes, LEVANTIN for vibrant Mediterranean flavors, and CROSS CULTURE CUISINE – a journey through international kitchens refined with local delicacies.



## SUSTAINABILITY IN ACTION

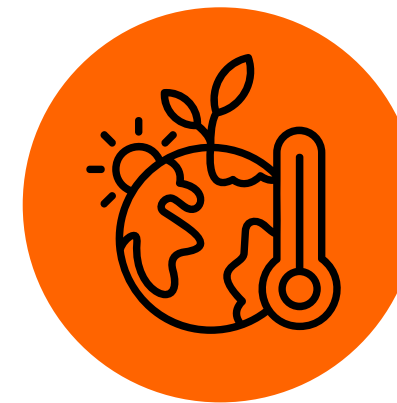

CLIMATE  
NEUTRAL



GREEN  
CUISINE

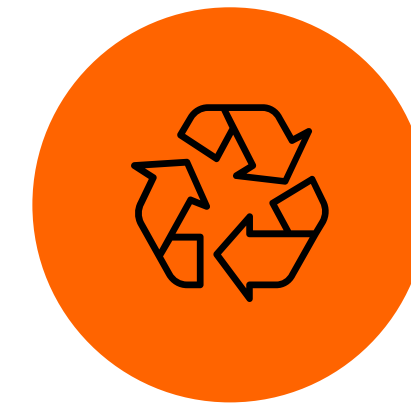

FOOD  
RECYCLING

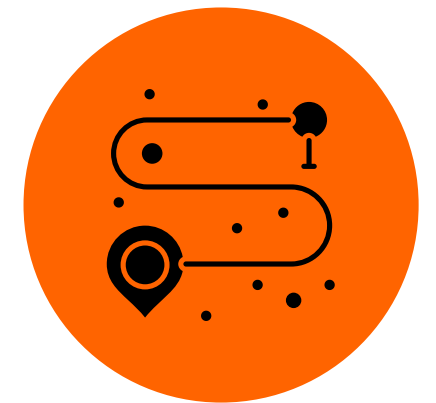

SHORT  
ROUTES



# WE ARE LOOKING FORWARD TO YOUR REQUEST!

**EUREF** *Event*★

## CONTACT:

✉ [mail@locations.euref.de](mailto:mail@locations.euref.de)

☎ +49 30 264 767-24

🌐 [www.euref-  
event.de/en](http://www.euref-event.de/en)

## LET'S CONNECT!

